

# Egg RPC

- Strong, interlocking design keeps weight on the RPC and off the eggs
- Superior ventilation means better cooling and a longer product shelf life
- Moisture-proof plastic protects eggs better: no weak, collapsing cardboard boxes



*A sturdy, food-safe reusable plastic container (RPC) specially designed for eggs. Cooling eggs three times faster to the recommended storage temperature of +45 °F/+7 °C<sup>1</sup>, it is ideal for point-of-sale (POS) display. The interlocking tabs allow secure stacking and more stable pallet loads.*

## Usability



Optimized for eggs

## Protects your eggs

Robust structure reduces broken and unsaleable eggs by up to 50 %<sup>1</sup>

Optimum ventilation means fresher eggs for longer

Innovative latch design ensures strength and reliability

Interlocking tabs enable secure and stable stacking

## Ideal in store

75 % faster one-touch stocking<sup>2</sup>

No need for box cutters or cardboard recycling

Hinged side folds out and under the crate for easy display

## Better for your staff and systems

Dramatic reduction in broken eggs means less cleaning up

Folds for more efficient use of storage space

Design allows 30 % faster pallet breakdown<sup>3</sup>

Standardized packaging works smoothly with automated equipment

## Helps you operate more sustainably

Reusable over many years, eliminating waste

After useful life, material is recycled into new RPCs

Reduced waste, pollution and use of natural resources<sup>4</sup>

## Standardized for maximum convenience

Compatible with all standard pallets

Optional graphics and labels for branding available

Pooled and serviced through IFCO's network of service centres

1. IFCO customer trials comparing RPCs with disposable packaging  
 2. IFCO retail store time studies  
 3. California Polytechnic State University, 2015  
 4. Comparative Life Cycle Assessment of Reusable Plastic Containers conducted by Franklin Associates, a Division of Eastern Research Group (ERG), March 2017

## Dimensions and specifications

Egg RPC

TYPE		6321E	6333E
Dimensions	External L x W – Folded	60.3 x 33.43 cm	60.3 x 33.43 cm
		23.74 x 13.16 in	23.74 x 13.16 in
	External H – Folded	7.28 cm	8.28 cm
		2.87 in	3.26 in
	External H – Folded stacked	6.48 cm	7.48 cm
		2.55 in	2.95 in
	Weight	4.30 lbs	6.10 lbs
	External L x W – Opened	60.3 x 33.43 cm	60.3 x 33.43 cm
		23.74 x 13.16 in	23.74 x 13.16 in
	External H – Opened	21.65 cm	34.75 cm
8.52 in		13.68 in	
External H – Opened stacked	20.15 cm	33.25 cm	
	7.93 in	13.09 in	
Logistics*	Number of folded RPCs on pallet	108	96
	Number of open RPCs on pallet	60	30
Material	Material	Polypropylene	
	Color	FDA black	

\* With 6-in/15.24-cm pallet | RPC = Reusable Plastic Container

## Additional information

Features	Excellent colour durability; resistant against UV radiation; food-grade polypropylene; FDA-approved colorant
Temperatures	Usable from +14 °F/–10 °C up to +140 °F/+60 °C (for short periods up to +194 °F/+90 °C)

## Notes on use

### Opening



- 1 Open the long side walls by pulling them upright. Pull the sliding wall outward, away from the container
- 2 Push up the short side walls until they snap into the locks
- 3 Press the edges until the locks are fixed

### Closing

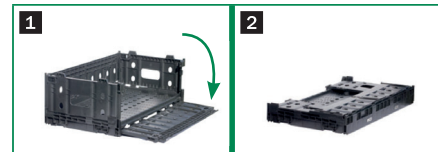

- 1 Open the tabs on the front wall and pull the wall outward, away from the container. Slide the wall into the base and into locked position
- 2 Fold down the long side wall onto the short side walls

### Stacking



All information without guarantee and subject to change without notice.

## IFCO SYSTEMS US, LLC

3030 N Rocky Point Drive | Suite 300 | Tampa, FL 33607 USA

T: +1 813 463 4100 | F: +1 813 286 2070

www.ifco.com

© IFCO 03/2017 – All Rights Reserved

**IFCO**

A Brambles Company